



2018 CSIA Executive Conference

Exhibitor Assignments

As of 4/5/2018

Booth #	Organization Name
3	Schmersal Inc.
4	Schneider Electric – Hardware
5	Phoenix Contact
6	Automationtechies
7	GE Digital
8	Alliantgroup
9	Rockwell Automation
10	AVEVA
11	International Society of Automation
12	Red Lion Controls
13	WIN-911 Software
14	Acromag
15	Advanced Cooling Technologies
16	Beijer Electronics
17	Secomea Inc.
18	Softing Inc
21	Unitronics
22	Volt480
23	Honeywell
24	ESTeem Wireless Modems
25	Belden
26	Tatsoft LLC
27	WEBALO, INC.
28	Hilscher NA
29	Bedrock Automation
30	Canary Labs
31	Heritage Manufacturing
32	KEB America
33	Tosibox, Inc
34	Ubidots
37	Seeq
38	Sepasoft

39	PTC
40	Lantronix
41	Panduit
42	ProComSol, Ltd
43	Altizon Systems
44	Jama Software
45	Stratus
46	ABB, Inc.
47	Inductive Automation
48	Flow Software
49	Evans Consoles Incorporated
50	Festo Corp
51	CONTEC Americas
52	Clayton & McKervey
55	NEXCOM
56	Opto 22
57	HAL Software
58	Blue Ridge Networks
59	CAS Dataloggers
60	Carlton-Bates Company
61	Mitsubishi Electric
62	B&R Industrial Automation
63	Inductive Automation
64	Software Toolbox Inc
65	Skkynet
66	eRPortal Software, Inc.
67	Delta Products Corporation
68	R. STAHL, Inc.
71	AVEVA
72	Siemens Industry, Inc.
73	Cisco Systems, Inc.
74	ICONICS
75	Rutamssoft
76	Saginaw Control & Engineering
77	Littelfuse
78	CSIA

CSIA

APRIL 25TH, 2018

HYATT REGENCY - PACIFIC CONCOURSE A-G - SAN FRANCISCO, CA

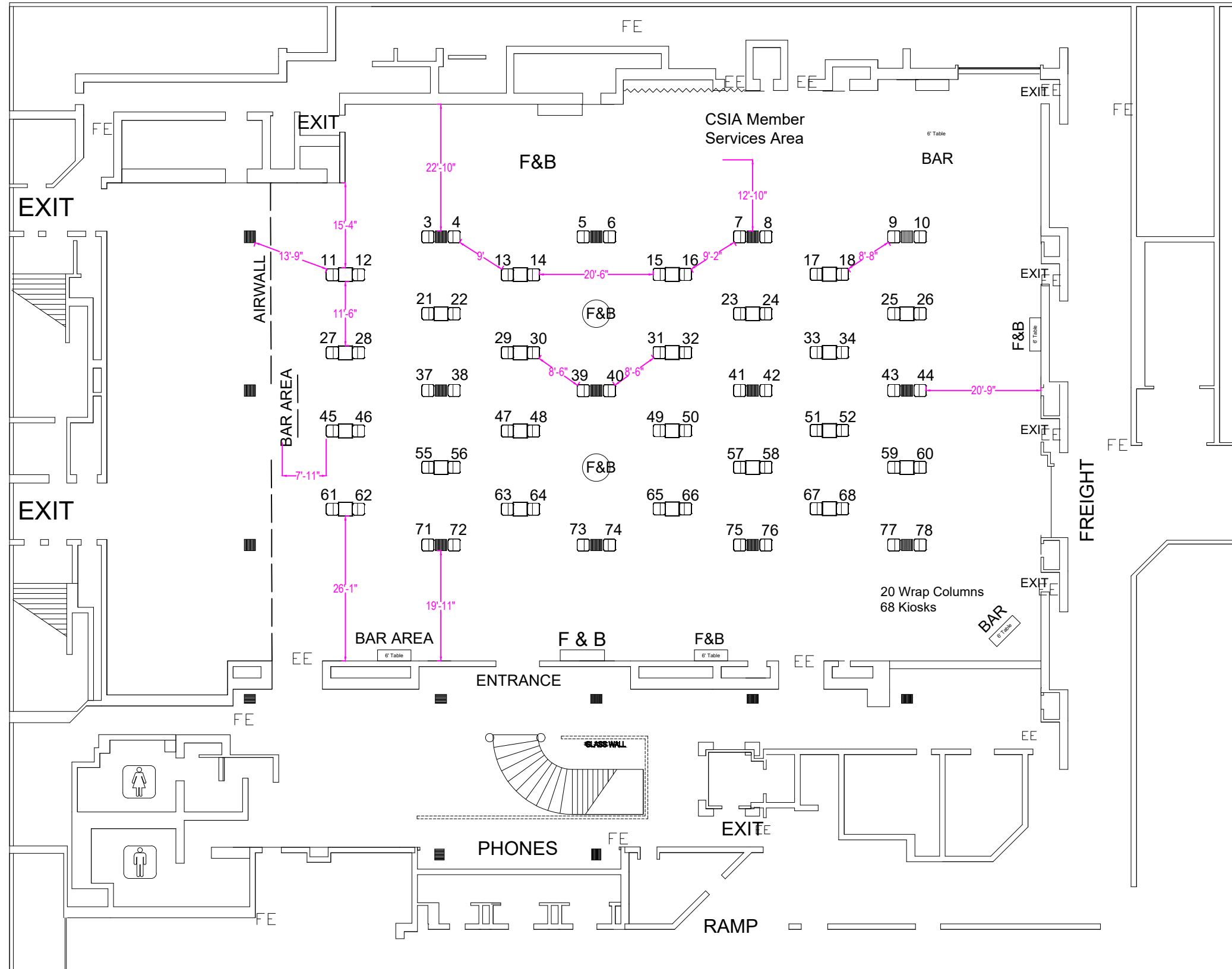

REVISION
Date: 3/15/2018
By: RENEE THAVICHAIGARN

BOOTH COUNT

BLDG. LEGEND:

DRAWING INFO

Passport Line Item Number:
#4354909
Facility:
HYATT REGENCY
Hall / Level:
PACIFIC CONCOURSE A-G
City & State:
SAN FRANCISCO, CA
Scale: CUSTOM
Job #: 464489
AE: ACCOUNT EXEC
Prod. AE: PRODUCING EXEC
Started: 3/13/2018
Started By: RENEE THAVICHAIGARN
Prod. Branch: SAN FRANCISCO, CA

FREEMAN

Disclaimer - Every effort has been made to ensure the accuracy of all information contained on this floor plan. However, no warranties, either expressed or implied, are made with respect to this floor plan. If the location of building columns, utilities or other architectural components of the facility is a consideration in the construction or usage of an exhibit, it is the sole responsibility of the exhibitor to physically inspect the facility to verify all dimension and locations.
© Copyright 2007, Freeman Co. All rights reserved.
Confidential and Proprietary - the information contained herein is the proprietary information of Freeman and by accessing the information, the recipient agrees to keep the information confidential and not disclose it to any third party without the prior consent of Freeman. Recipient also agrees to only use the information for its internal evaluation purposes and for no other purpose, without the prior consent of Freeman.

File Path: O:\Design\Floorplans\Shows\2018\4-April\CSIA 0418 (J)\DWG\CSIA 0418 PACIFIC.dwg | Tab Name: OVERALL